



# SEA-BIRD ELECTRONICS, INC.

1808 136th Place N.E., Bellevue, Washington 98005 USA

Telephone: (425) 643-9866 Telex: 292915 SBEI UR

Fax: (425) 643-9954

email: seabird@seabird.com

SBE P/N 90087

DATE	REV	REVISION RECORD	AUTH	DR	CHK
6.17.03	A	ADDED PN 30579	CB	KLP	
9.3.03	B	Add drawing, 30458, additional 30389	CB	MJ	

## Universal Profiler/Pump Plumbing Kit

### Kit Contents

SBE P/N	Manufacturer P/N	Primary SBE Application	QTY
23337	Pump Air Release Plug	Air Bleed for Y-Fitting	1
30387	Tube, 1/2" Y-Fitting	Top connection for plumbing	1
30388	Vinyl tubing, 3/4" x 1/2"	Main Plumbing tube	4 ft
30389	Cable tie, 4"	Secure plumbing to fittings	20
30458	Cable Tie, 15"	Secure Y-Fitting to CTD Housing	2
30579	Tube, 3/8" ID 1/2" OD	For DO Sensor	0.5 ft

### APPLICATIONS:

#### Top Air Bleed Valve

SBE P/N	Part Description	Primary SBE Application	QTY
23337	Pump Air Release Plug	Air Bleed for Y-Fitting	1
30387	Tube, 1/2" Y-Fitting	Top connection for plumbing	1
30388	Vinyl tubing, 3/4" x 1/2"	Main Plumbing tube	≈ 3"

1. The air release (23337) installs into the single end of the Y-fitting (30387) such that the flat side of the air bleed faces out, and the concave side faces the "Y".
2. Slide a 3-4" length of heavy tubing (30388) over the air bleed side. This will be the top of your plumbing arrangement.

#### Replacement sensor plumbing

SBE P/N	Part Description	Primary SBE Application	QTY
30388	Vinyl tubing, 3/4" x 1/2"	Main Plumbing tube	4 ft
30389	Cable tie, 4"	Secure plumbing to fittings	4
30579	Tube, 3/8" ID 1/2" OD	Goes on hose barb of DO Sensor	0.5 "

1. If applicable, cover the DO hose barbs with a 0.5" piece of 30579.
2. Use the 30388 heavy tubing to form a flowing path through each sensor ducting system.
3. Use the small cable ties (30389) to make a good connection at tubing/sensor interface points.
4. Refer to the diagrams in drawing 41223 or App Note 64-1.

Drawing: 41223

### Sea-Bird Electronics Procedure

PROCEDURE NUMBER: 67108

TITLE: **SBE PN 90087 Universal Profiler/Pump Plumbing Kit**

REVISION: **B**

EFFECTIVE DATE: **9/03/2003**

CHECKED BY:

PAGE 1 of 1

Secure each tubing connection with 2 cable ties (not shown)

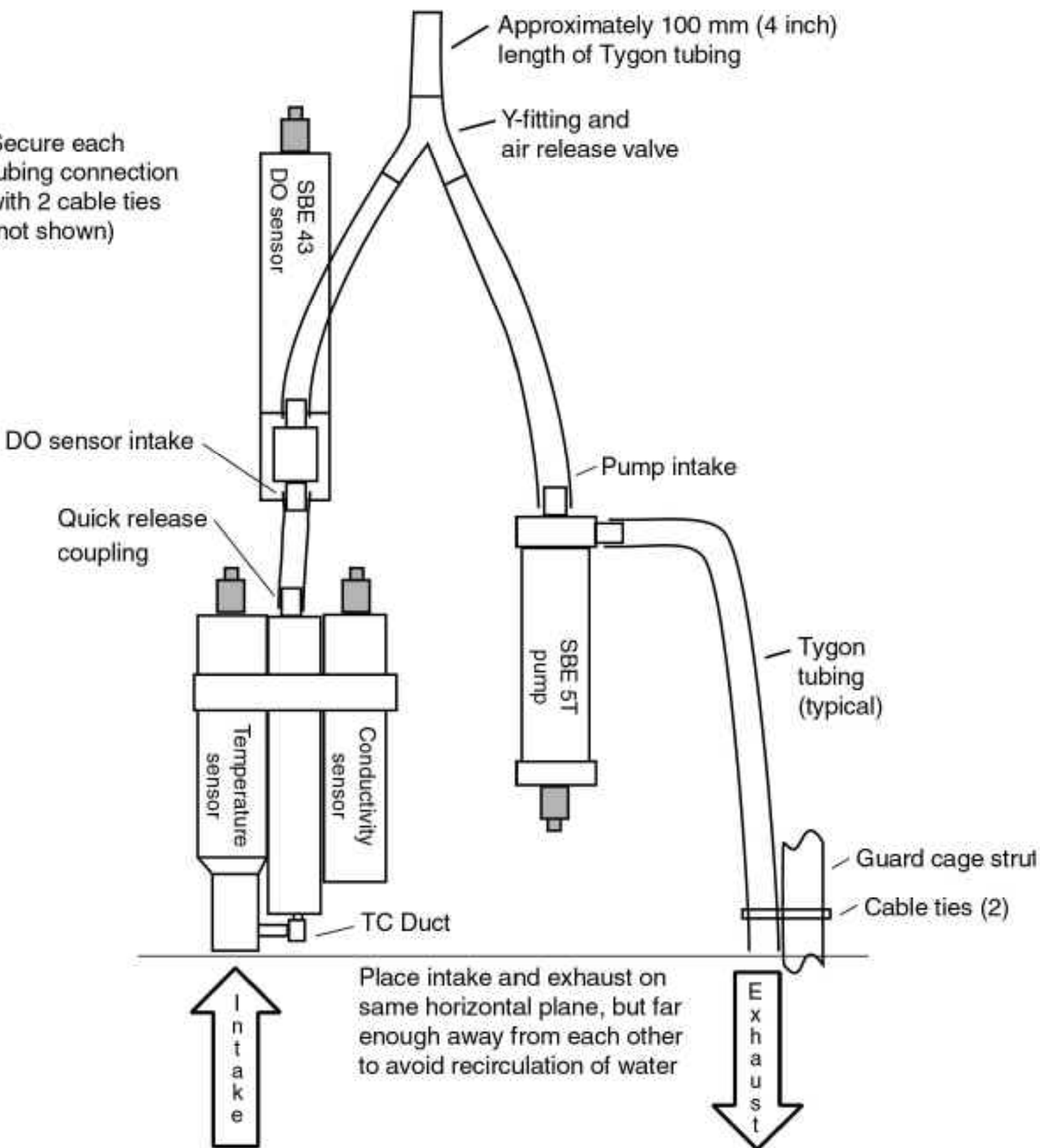

Place pump exhaust above intake and DO sensor, with exhaust outlet 'corner' up

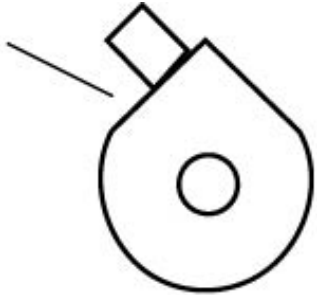

Secure each tubing connection with 2 cable ties (not shown)

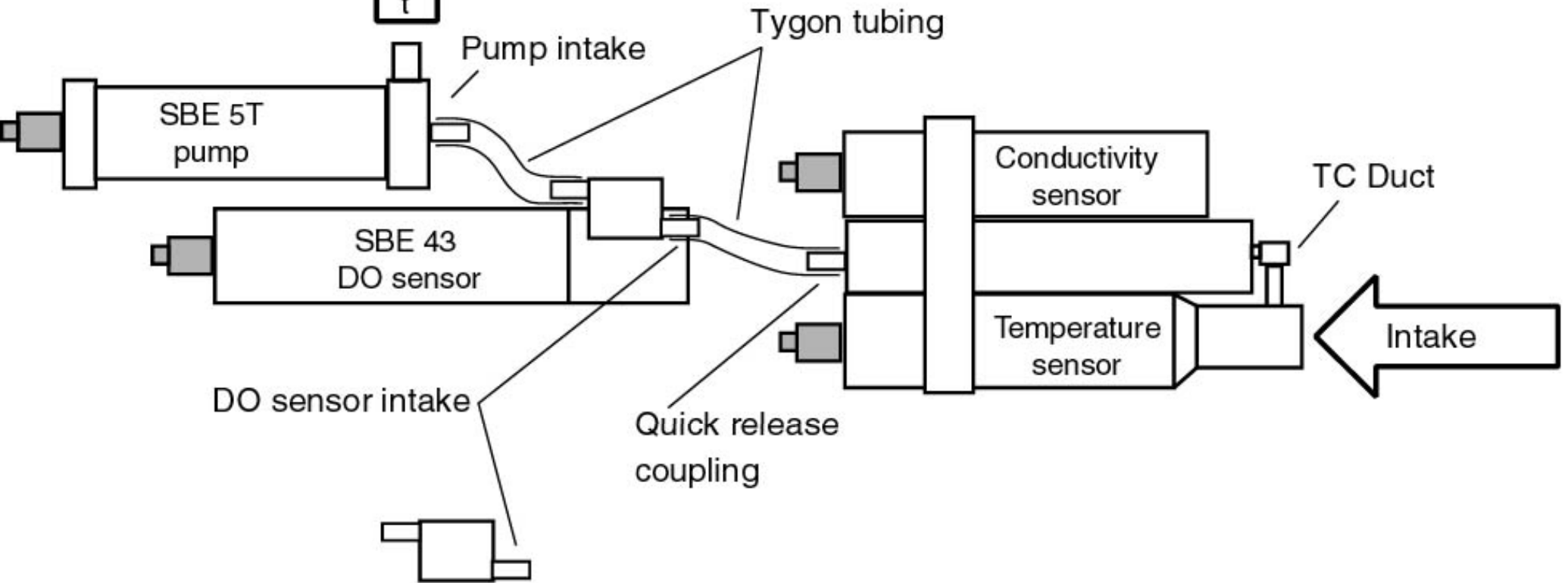
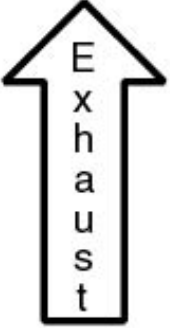

Place DO sensor with exhaust above intake, oriented as shown ( $\pm 45^\circ$ )