



SEA -B I R D E L E C T R O N I C S, I N C.

1808 136th Place N.E., Bellevue, Washington 98005 USA

Telephone: (425) 643-9866 Telex: 292915 SBEI UR

Fax: (425) 643-9954

email: seabird@seabird.com

SBE P/N 90088

DATE	SYM	REVISION RECORD	AUTH	DR	CHK
01.99	A	Added drawing, more instructions	MJ		

SBE TC Duct Tubing Kit

Kit Contents

SBE P/N	Manufacturer P/N	Primary SBE Application	QTY
23337	Pump Air Release Plug	Air Bleed for Y-Fitting	1
30382	Tygon Tube, 1/4ID x 1/32 wall	Spare Temp/Cond Connector tubing	1 piece
30383	Tygon Tube, 1/4ID x 1/8 wall	Spare C-Duct fitting tube	1 piece
30384	Tygon Tubing, 3/4" x 1/2"	Soaker hose for conductivity cell	1 ft
30387	Tube, 1/2" Y-Fitting	Top connection for plumbing	1
30388	Vinyl tubing, 3/4" x 1/2"	Main Plumbing tube	4 ft
30389	Cable tie, 4"	Secure plumbing to fittings	12

APPLICATIONS:

Top Air Bleed Valve

SBE P/N	Part Description	Primary SBE Application	QTY
23337	Pump Air Release Plug	Air Bleed for Y-Fitting	1
30387	Tube, 1/2" Y-Fitting	Top connection for plumbing	1
30388	Vinyl tubing, 3/4" x 1/2"	Main Plumbing tube	≈ 3"

1. Air release (23337) installs into the single end of the Y-fitting (30387) such that flat side of air bleed faces out, and concave side faces the "Y".
2. Slide about a 3-4" length of heavy tubing (30388) over the air bleed side. This will be the top of your plumbing arrangement.

Spare C-Duct tubing

SBE P/N	Part Description	Primary SBE Application	QTY
30382	Tygon Tube, 1/4ID x 1/32 wall	Spare Temp/Cond Connector tubing	1 piece
30383	Tygon Tube, 1/4ID x 1/8 wall	Spare C-Duct fitting tube	1 piece
30384	Tygon Tubing, 3/4" x 1/2"	Used with C-Duct fitting tube	≈ 1"

1. Use ≈ 3/16" length of thicker tubing (30383) as a base for the C-Duct fitting.
2. Install ≈ 1-1/2" length of conductivity cell tubing (30384) onto this piece.
3. Install assembly onto c-duct on the side that changes diameters. Push it all the way down.
4. C-Duct installs into bottom end of cell with this seal assembly.
5. Slip ≈ 1" length of the thinnest tubing (30382) over other end of C-Duct.
6. This will allow a good seal between the C-duct and the T-duct.

Replacement sensor plumbing

SBE P/N	Part Description	Primary SBE Application	QTY
30388	Vinyl tubing, 3/4" x 1/2"	Main Plumbing tube	4 ft
30389	Cable tie, 4"	Secure plumbing to fittings	12

1. Use the 30388 heavy tubing to form a flowing path through each sensor ducting system.
2. Use the small cable ties (30389) to make a good connection at tubing/sensor interface points.
3. Refer to the included diagram for an idea of how to plumb a standard CTD.

SBE Drawings:

41223 SBE Inertia-Balanced Plumbing Configuration

Sea-Bird Electronics Procedure

PROCEDURE NUMBER: 67018

TITLE: SBE PN 90088 TC Duct Tube Kit Assembly

REVISION: A

EFFECTIVE DATE: 11/07/2002

CHECKED BY: _____ PAGE 1 of 1

Secure each tubing connection with 2 cable ties (not shown)

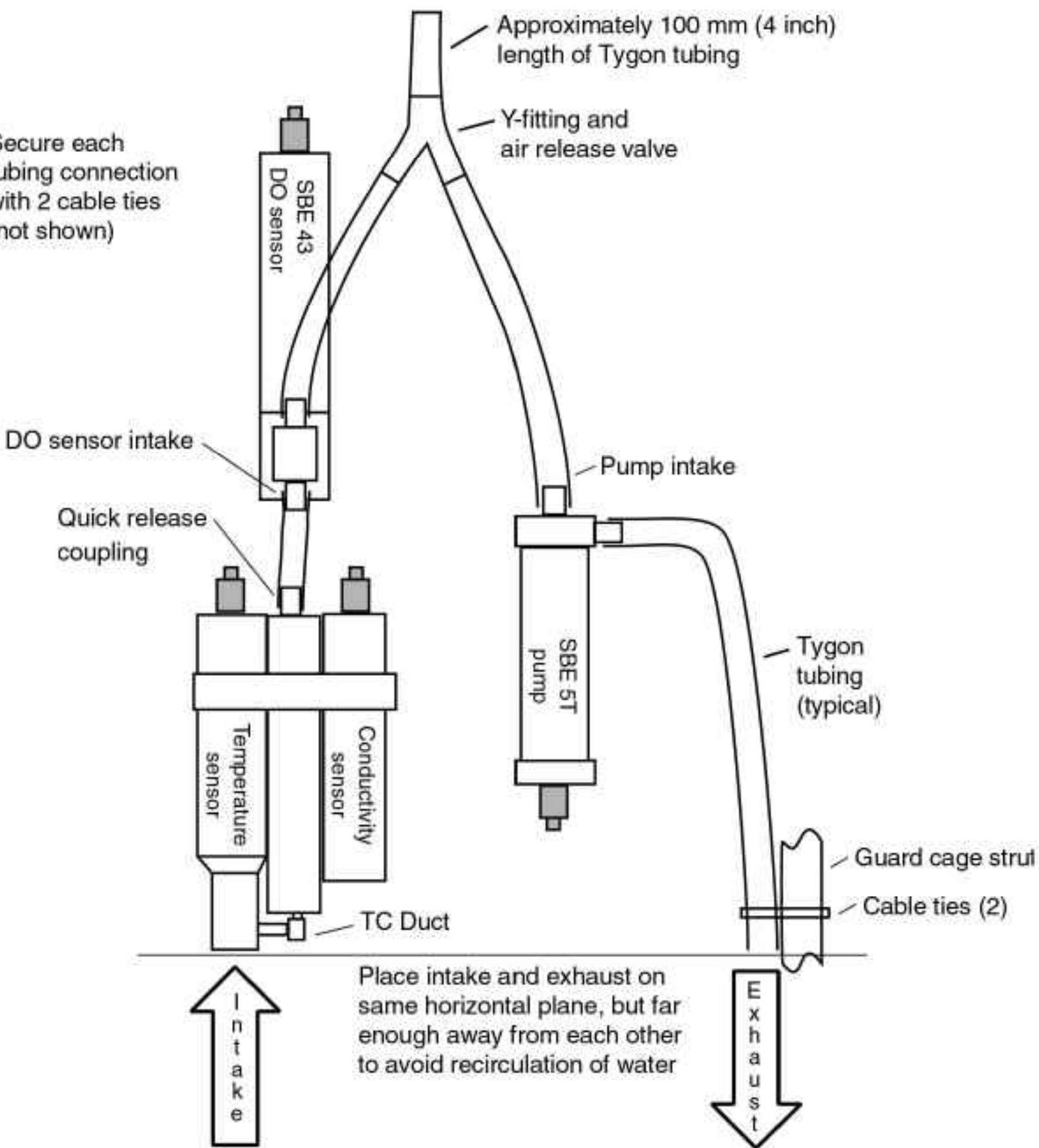

Place pump exhaust above intake and DO sensor, with exhaust outlet 'corner' up

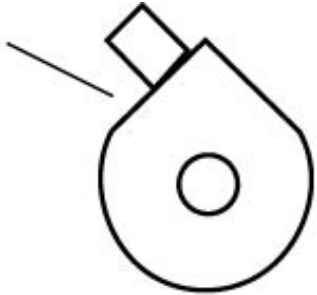

Secure each tubing connection with 2 cable ties (not shown)

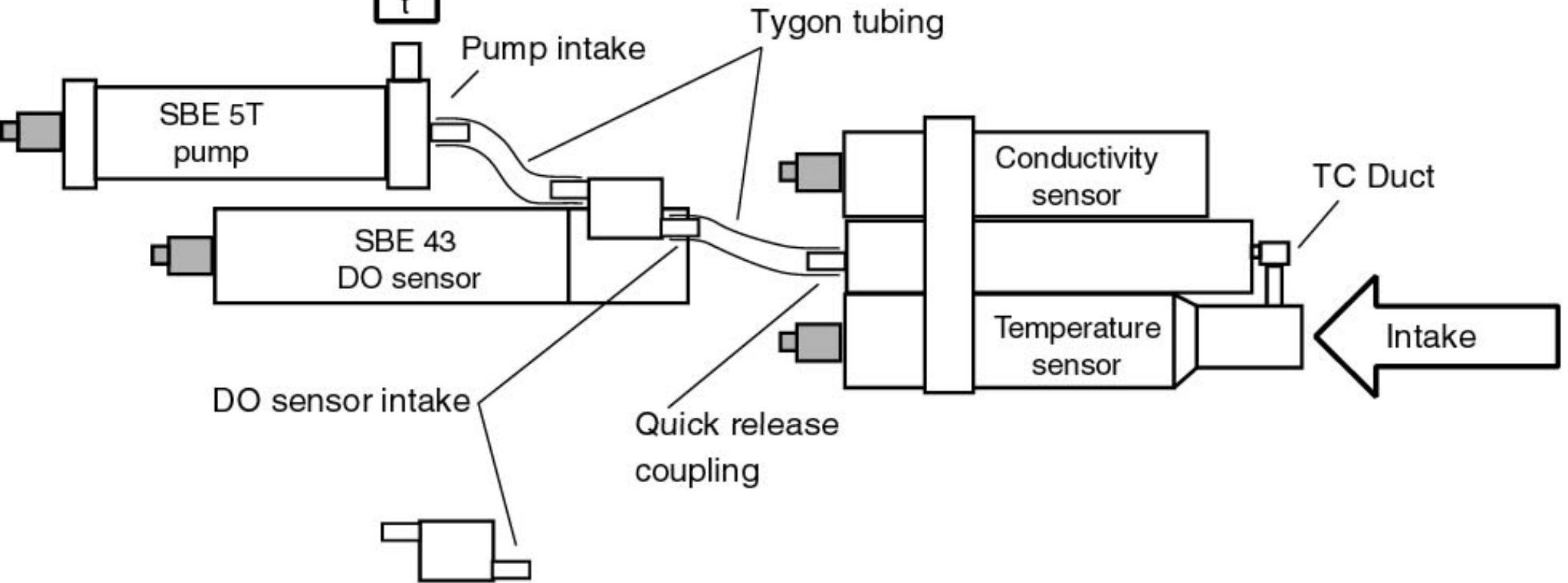
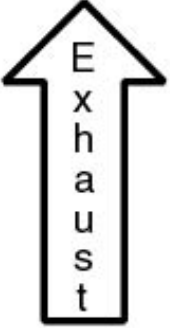

Place DO sensor with exhaust above intake, oriented as shown ($\pm 45^\circ$)