



SEA-BIRD ELECTRONICS, INC.

1808 136th Place N.E., Bellevue, Washington 98005 USA
Telephone: (425) 643-9866 Telex: 292915 SBEI UR
Fax: (425) 643-9954 email: seabird@seabird.com

SBE P/N VARIES

DATE	SYM	REVISION RECORD	AUTH	DR	CHK
08/24/06	A	Add LI-192SA Instructions	MJ	PL	CB

SBE32 12-Place to Li-Cor Mount Kit

Kit Contents: Table 1

SBE P/N	Manufacturer P/N	Primary SBE Application	QTY
VARIES (See Table 2)	SBE 32 12PI Li-Cor Mount Block	3 pieces: Main Sensor Mount Assembly	1
30161	Mach screw, 8-32 x 7/8 PH SS	Secure Li-Cor sensor into Mount	2
30377	Bolt, 1/4-20 x 1-1*4 Socket SS	Secure Mount Clamp to Top Bar of Carousel Frame	2

Kit Contents: Table 2

KIT P/N	Mount Block P/N	Primary SBE Application	QTY
50169	23977	LI-193SA Mount kit to SBE 32 1" Carousel frame, 3 pieces	1
50415	233442	LI-192SA Mount kit to SBE 32 1" Carousel frame, 3 pieces	1

Procedure for Kit Assembly

Drawing number 67056

A. Assembling the mount and sensor together

1. LI-193SA

- Lay out 3 pieces of mount block (23977) such that the 2 notched pieces have their notches facing up, and are together.
- Li-Cor installs between these 2 pieces, with the bulb on the same side as the notches.
- Secure Li-Cor sensor to mount block by hand with 2 screws (30161) until just snug.

2. LI-192SA

- Lay out 3 pieces of mount block (233442) such that the rounded end piece and the part of the main block with #8 holes are together. Li-Cor installs between these 2 pieces.
- Secure Li-Cor sensor to mount block by hand with 2 screws (30161) until just snug.

B. Installing the Li-Cor Sensor

- Align mount such that Li-Cor sensor and all notches (if applicable) are facing up.
- Mount block assembly installs onto the top end of any vertical support bar on the Carousel cage frame.
- Secure assembly to cage with the 3rd piece of mount block and 2 bolts (30377).
- Tighten bolts by hand, just until snug.

Please Note: Sensor *MUST* be installed with the bulb facing upright in order to achieve good readings.

SBE Drawings:

67056A SBE32 to Li-Cor Mount Installation

Sea-Bird Electronics Procedure

PROCEDURE NUMBER: **67056**

TITLE: **SBE32 12-Place to Li-Cor Kit**

REVISION: **A**

EFFECTIVE DATE: **08/24/2006**

CHECKED BY:

PAGE 1 of 1

DATE	SYM	REVISION RECORD	AUTH.	DR.	CK.
8.24.06	A	ADDED PN TABLE	MJ	PL	CB

SBE 32 VERTICAL SUPPORT
BAR (SECTIONAL VIEW)

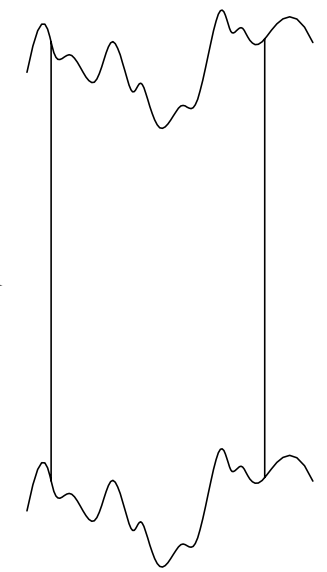

LI-COR SENSOR
(SECTIONAL VIEW)
(LI-193SA SHOWN)

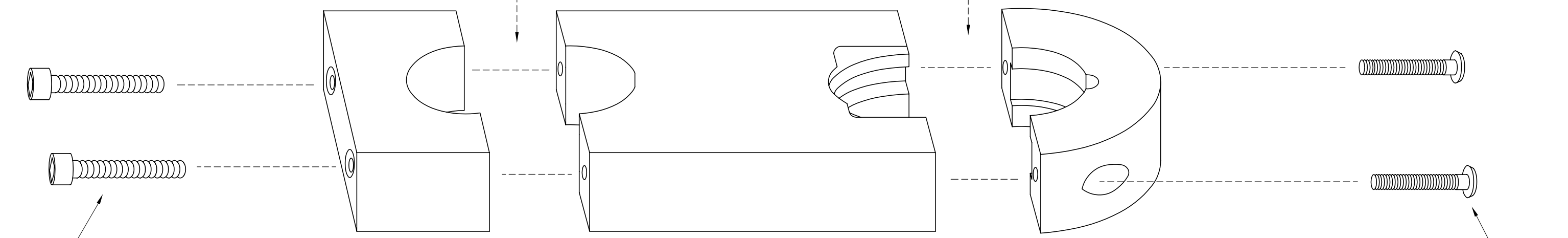
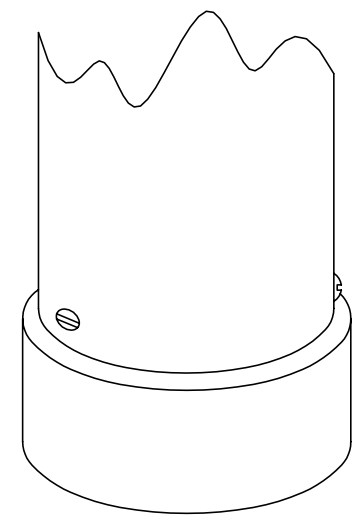

P/N 30377, BOLT 1/4-20 X 1-1/4"
SOCKET CAP, SS (2 PLACES)

P/N 30161, MACH SCREW
8-32 x 7/8" PH, SS (2 PLACES)

P/N VARIES, SEE TABLE, SBE 32 12PL
LI-COR MOUNT BLOCK (3 PC. SET)

Δ	KIT P/N	MOUNT BLOCK P/N	LI-COR SENSOR
	50169	23977	LI-193SA
	50415	233442	LI-192SA

TOLERANCES	SEA-BIRD ELECTRONICS, INC			
FRACTIONAL	P/N SEE TABLE	SCALE NTS	DRAWN BY CEG APPROVED BY	
DECIMAL	TITLE SBE 32 12 PLACE LI-COR MOUNT KIT ASSEMBLY			
ANGULAR	DATE 9.26.98	DRAWING NUMBER	67056	REV A